

# Installation Instructions for LED Panel Light

**Attention :** In order to make the lamps installed correctly, please read this instruction after opening the box and keep it properly.

## Product Introduction:

It is made of aluminum house with simple and reasonable structure, Good appearance with superior thermal performance. Use high bright white LEDs as light sources, no UV or IR radiation. Environmental friendly no light pollution, no mercury, long lifespan, instant on/off and color rendering index is very high.

## Application:

Suitable for hotel, exhibition hall, airport, theatre, mall, schools, meeting room and other indoor places lighting.

## Technical Parameters:

Model	YS-PL60601-40W
Power(W)	40
Voltage ( V )	95 ~ 277
Frequency ( Hz )	50/60
Rated current(A)	0.7
Operating environment(°C/RH)	-25 ~ 40/10% ~ 90%
Life time(H)	50000

Power factor	0.92
Total harmonic distortion	≤ 18%
Light output(Lm)	3900
CCT(K)	6000
CRI	81
R9	2

## Installation instructions:

1. Turn off the power switch
2. Connect the input-terminal with utility power(AC 95 - 277V) by using wiring-unit, make certain that no copper wire is bared
3. Connect the output-terminal DC plug of current driver with the lamp's DC plug, insure this connection secure
4. Fix the lamp and current driver to the suitable place by convenient installation
5. Turn on the power switch

### Schematic diagram for embedded installation

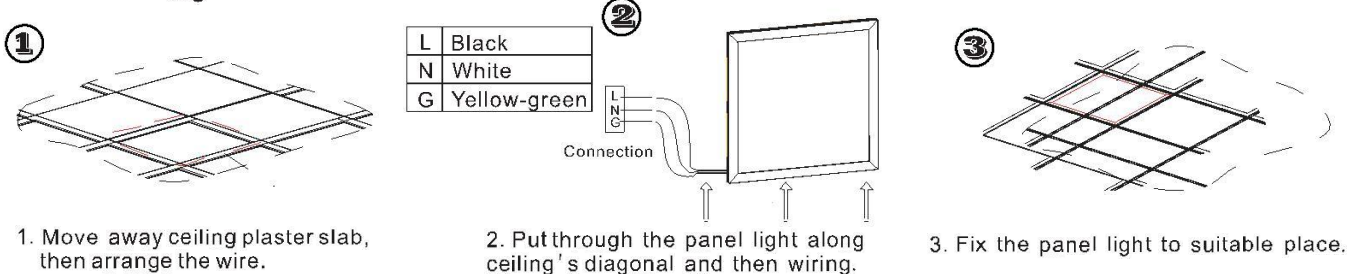

### Schematic diagram for suspension installation

Steel cable is not for free, please use your own or do a purchase in advance

1. The deck is removed, and the self-tapping screws into the deck within
2. The deck is fixed on the ceiling
3. The card line lock onto deck
4. Regulate the rope length, connect the power, you can power use

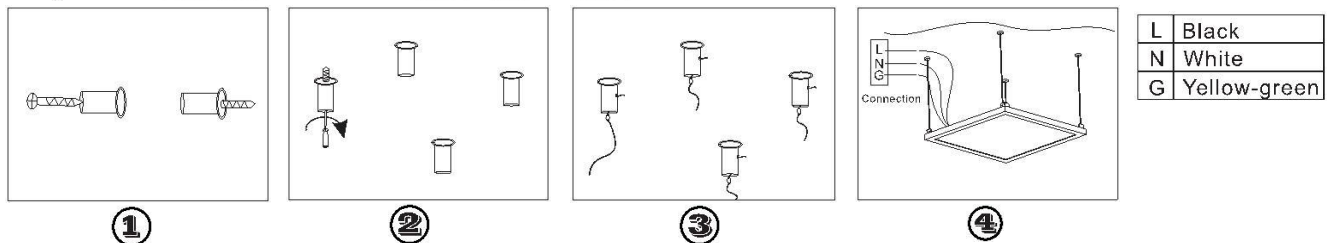

## Attentions:

1. Put off electricity before mounting. Do not use the LED Downlight exceed the input Voltage on Light's Label, or it will damage the downlight.
2. Do not remove , exchange any parts of lights.